



# NILU CONSTRUCTION PVT. LTD.

[CIN : U45400WB2009PTC134334]

GSTIN : 19AACCN9790K1ZO

Regd. Office : "Orion House", 138E, Ustad Enayet Khan Avenue, Kolkata - 700 017  
Phone : (033) 4804 5579

E-mail : oriongroupkolkata@gmail.com • Website : www.orionproperties.in

Ref. No. : .....

Date : .....

## PROJECT:

**G+X STORED (36.6 MT. HEIGHT) RESIDENTIAL BUILDING PLAN U/S 393A OF K.M.C ACT 1930 AND K.M.C BUILDING RULE 2009 AT PREMISES No: 90 A GARDEN REACH ROAD IN WARD - 075, BOROUGH - IX, P.S - WATGUNGE, KOLKATA - 700023**

## APPLICANT

**M/S NILU CONSTRUCTION PRIVATE LIMITED**

LATITUDE: 22° 32' 47"

LONGITUDE: 88° 19' 20"

LATITUDE & LONGITUDE HAS BEEN MEASURED NEAR THE CENTER OF THE PLOT.

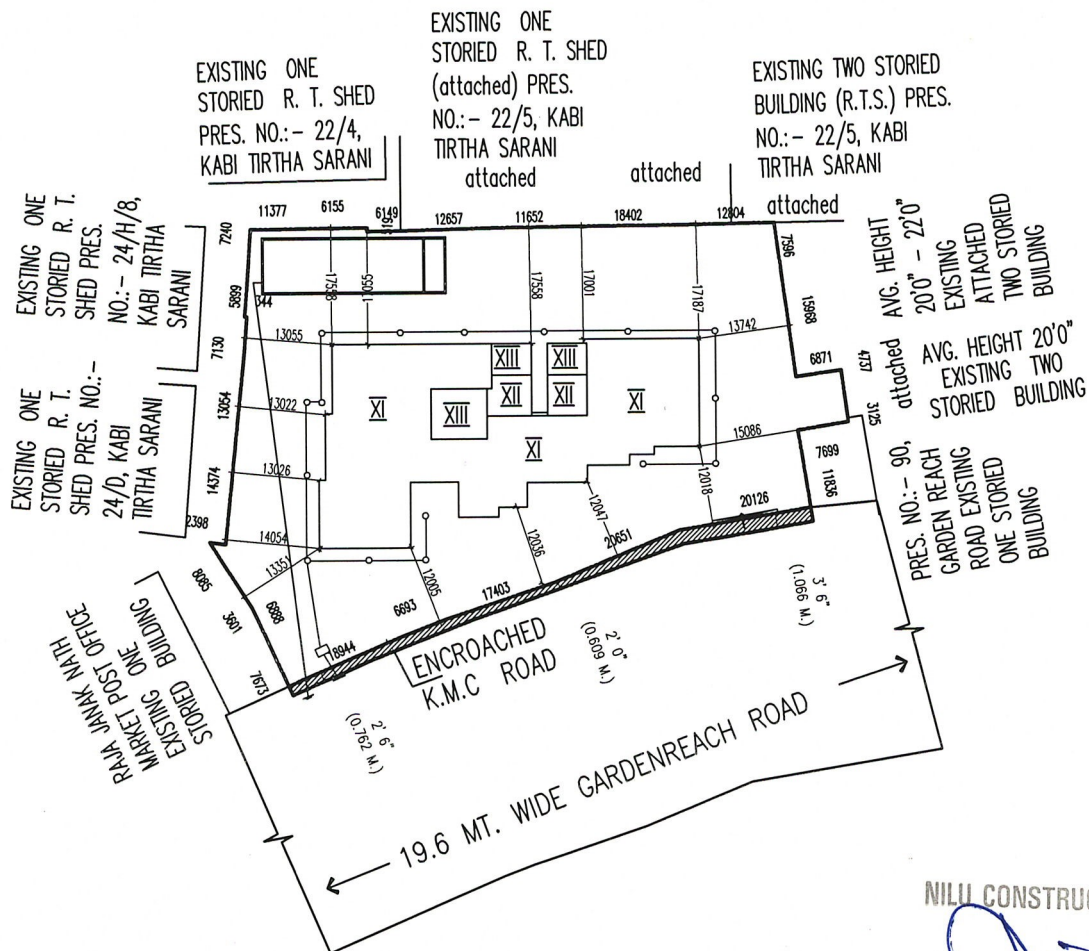

SITE PLAN  
SCALE-1:600

NILU CONSTRUCTION PVT. LTD.  
  
 Director